



CYGNUS CATALOGUE 2019

ULTRASONIC THICKNESS GAUGES, HATCH COVER
LEAK DETECTOR & FLOODED MEMBER DETECTOR



CONTENTS

Page

Surface Thickness Gauges, Probes & Leads

Cygnus 2 HANDS FREE	2
Cygnus 2+ HANDS FREE	3
Cygnus 4 GENERAL PURPOSE	4
Cygnus 4+ GENERAL PURPOSE	5
Cygnus 6+ PRO	6
Cygnus 1 INTRINSICALLY SAFE ATEX	7
Cygnus 1 INTRINSICALLY SAFE CSA	8
Cygnus HEAVY DUTY	9

Subsea Thickness Gauges, Probes & Leads

Cygnus DIVE Mk2	10-12
Cygnus UNDERWATER	13
Cygnus ROV Mountable 2/4 km	14-15
Cygnus MINI ROV Mountable	16

Thickness Gauge Probes, Spares & Accessories

Cygnus Probes	17
Probe Leads	18
Knurled Rings & Membranes (spares)	19
Accessories	20
Carry Cases & Gauge Bodies	21
Spares for previous models	22

Flooded Member Detector

Cygnus FMD	22-23
------------	-------

Hatch Cover Leak Detector

Cygnus HATCH SURE	24
-------------------	----

Guide to Serial Numbers for Cygnus Gauges

25



Cygnus 2 HANDS FREE

Multiple Echo Ultrasonic Thickness Gauge

The Cygnus 2 HANDS FREE is housed in an extremely tough, rubber sealed enclosure with in-built display and extra durable buttons. Designed for use in rope access or belt mounted applications where the end-mounted organic LED display can be easily read whilst taking measurements. The Cygnus 2 is supplied in a protective carry case.



Cygnus 2 HANDS FREE Kit

Cygnus 2 HANDS FREE Mk5 UTG Kit, without Probe

Contents: Ultrasonic Thickness Gauge - 3 x AA batteries, steel test block - ultrasonic & membrane couplant - accessory pouch - neck & wrist straps & fixings - mini USB to USB cable - manual & carry case (The gauge has a Lemo 1 connector)

Please select probe(s) & lead(s) from the lists below:

Order Code

050-2000/5



Single Crystal Probes for Cygnus 2 HANDS FREE Gauges

(All Probes are supplied with 20 membranes & membrane key)

Probe S2C Single 2.25MHz 13mm with BNC connector	004-9500
Probe S2D Single 2.25MHz 19mm with BNC connector	004-9502
Probe S3C Single 3.5MHz 13mm with BNC connector	004-9504
Probe S5C Single 5MHz 13mm with BNC connector	004-9508
lead for use with the above single crystal probes & a Cygnus 2:	
Probe Lead Lemo 1 - BNC 1.4m (4'6")	004-0406



Probe S5A Single 5MHz 6mm with Single Lemo 00 connector	004-9507
lead for use with the S5A probe & a Cygnus 2:	
Probe Lead Single Lemo 1 - Single Lemo 00 1.35 m (4'6")	004-0401



Right Angle Probe for Cygnus 2 HANDS FREE Gauges

(All right angle probes are supplied with 1.35 m integral probe lead with a Lemo 1 connector, 20 membranes & membrane key)

Right Angle Probe S2C 2.25MHz 13mm Lemo 1 (integral cable)	001-9387
Right Angle Probe S3C 3.5MHz 13mm Lemo 1 (integral cable)	001-9389
Right Angle S5A Probe 5MHz 6mm (1/4") Lemo 1(integral cable)	001-9390

Marinised (underwater) Probes for Cygnus 2 HANDS FREE Gauges

(Please add Marinised Cable length as required for all Marinised Probe orders. Cable includes a Lemo 1 connector to connect with the gauge)

Marinised Probe S2C 2.25MHz 13mm	002-9387
Marinised Probe S2D 2.25MHz 19mm	002-9388
Marinised cable for use underwater priced per metre	001-0434
(50m max. length for "S2-" (2.25MHz) probes, for other frequencies please contact Cygnus)	

Accessories for Cygnus 2 HANDS FREE

Neck Strap with fixings for C2 / 2+ / 4 / 4+ / 6+ Mk5 UTG (supplied as part of gauge kit)	050-0115
Hand Strap with fixing for C2 / 2+ / 4 / 4+ / 6+ Mk5 UTG (supplied as part of gauge kit)	050-0110
Belt Clip with fixing for C2 / 2+ / 4 / 4+ / 6+ Mk5 UTG	050-0100
Peli Carry Case for Cygnus 2 / 2+ / 4 Mk5 UTG Gauge Kit	050-4010/5



For Spare Leads see page 17 & for Spare Knurled Rings & Membranes page 18



Cygnus 2+ HANDS FREE

Multi-Mode Ultrasonic Thickness Gauge

All the benefits of the Cygnus 2, plus it can be used in 3 measuring modes:

- * Multiple Echo with Single Crystal probes
- * Echo-Echo with Twin Crystal probes
- * Single Echo with Twin Crystal probes



Cygnus 2+ HANDS FREE Kit

Cygnus 2+ HANDS FREE Mk5 UTG Kit, without Probe

Contents: Ultrasonic Thickness Gauge - 3 x AA batteries, steel test block - ultrasonic & membrane couplant - accessory pouch, neck & wrist straps & fixings - mini USB to USB cable - manual & carry case (The gauge has a Twin Lemo 00 connector)

Please select probe(s) & lead(s) from the lists below:

Order Code

050-2500/5



Single Crystal Probes for Cygnus 2+ HANDS FREE Gauges

(All Probes are supplied with 20 membranes & membrane key)

Probe S2C Single 2.25MHz 13mm with BNC connector	004-9500
Probe S2D Single 2.25MHz 19mm with BNC connector	004-9502
Probe S3C Single 3.5MHz 13mm with BNC connector	004-9504
Probe S5C Single 5MHz 13mm with BNC connector	004-9508

lead for use with the above single crystal probes & a Cygnus 2+:

Probe Lead Twin Lemo 00 to BNC 1.35m (4'6")	004-0410
---	----------



Probe S5A Single 5MHz 6mm with Single Lemo 00 connector	004-9507
---	----------

lead for use with the S5A probe & a Cygnus 2+:

#REF!	004-0412
-------	----------



Twin Crystal Probes for Cygnus 2+ HANDS FREE gauges

Probe T2C Twin 2MHz 12mm with Twin Lemo 00 connector	004-9550
Probe T5B Twin 5MHz 8mm (1/3") with Twin Lemo 00	004-9558

lead for use with the above twin crystal probes & a Cygnus 2+:

#REF!	004-0411
-------	----------



Probe T5A Twin 5MHz 10mm (3/8") integral cable Twin Lemo 00	004-9560
---	----------

Probe T7A Twin 7.5MHz 5mm 3/16" integral cable Twin Lemo 00	004-9575
---	----------



4 Step Test Block for use with Twin Crystal Probes (non-discountable items)

Test Block Steel 4 Step Metric 2.5 - 20mm 2.5/5/10/20	001-4858
Test Block Steel 4 Step Imperial 0.1 - 0.75 inch	001-4859



Marinised (underwater) Probes for Cygnus 2+ HANDS FREE Gauges

Marinised Probe S2C 2.25MHz 13mm	002-9387
Marinised Probe S2D 2.25MHz 19mm	002-9388

Marinised cable for use underwater priced per metre	001-0434
---	----------

(50m max. length for "S2-" (2.25MHz) probes, for other frequencies please contact Cygnus)

#REF!	050-0106
-------	----------

this adapter is required for using the above marinised probes with a "+" model Mk5 gauge



Twin Lemo 00 to Single Lemo 1 adapter

Accessories for Cygnus 2+ HANDS FREE

Neck Strap with fixings for C2 / 2+ / 4 / 4+ / 6+ Mk5 UTG (supplied as part of gauge kit)	050-0115
--	----------

Hand Strap with fixing for C2 / 2+ / 4 / 4+ / 6+ Mk5 UTG (supplied as part of gauge kit)	050-0110
---	----------



Belt Clip with fixing for C2 / 2+ / 4 / 4+ / 6+ Mk5 UTG	050-0100
---	----------



Peli Carry Case for Cygnus 2 / 2+ / 4 Mk5 UTG Gauge Kit	050-4010/5
---	------------

For Spare Leads see page 17 & for Spare Knurled Rings & Membranes page 18



Cygnus 4 GENERAL PURPOSE

Multiple Echo Ultrasonic Thickness Gauge

A compact general purpose Ultrasonic Thickness Gauge (UTG) giving accurate, error-checked through-coating measurements using our Multiple Echo technology. Highly versatile, can be used either right or left handed, in most industrial or shipping applications. The LCD display is easily read outdoors and is perfect for use in all light conditions. Vibration alert settings for user feedback.



Cygnus 4 GENERAL PURPOSE Kit

Cygnus 4 GENERAL PURPOSE Mk5 UTG kit, without Probe

Contents: Ultrasonic Thickness Gauge - 3 x AA batteries - steel test block - ultrasonic & membrane couplant - accessory pouch - neck & wrist straps & fixings - mini USB to USB cable - manual & carry case (The gauge has a Lemo 1 connector)

Please select probe(s) & lead(s) from the lists below:

Order Code

050-4000/5



Probes for Cygnus 4 GENERAL PURPOSE Gauges

(All Probes are supplied with 20 membranes & membrane key)

Probe S2C Single 2.25MHz 13mm with BNC connector	004-9500
Probe S2D Single 2.25MHz 19mm with BNC connector	004-9502
Probe S3C Single 3.5MHz 13mm with BNC connector	004-9504
Probe S5C Single 5MHz 13mm with BNC connector	004-9508
lead for use with the above single crystal probes & a Cygnus 4	
Probe Lead Lemo 1 - BNC 1.4m (4'6")	004-0406



Probe S5A Single 5MHz 6mm with Single Lemo 00 connector	004-9507
lead for use with the S5A probe & a Cygnus 4	
Probe Lead Single Lemo 1 - Single Lemo 00 1.35 m (4'6")	004-0401



Right Angle Probes for Cygnus 4 GENERAL PURPOSE Gauges

(All right angle probes are supplied with 1.35 m integral probe lead with a Lemo 1 connector, 20 membranes & membrane key)

Right Angle Probe S2C 2.25MHz 13mm Lemo 1 (integral cable)	001-9387
Right Angle Probe S3C 3.5MHz 13mm Lemo 1 (integral cable)	001-9389
Right Angle S5A Probe 5MHz 6mm (1/4") Lemo 1(integral cable)	001-9390

Marinised (underwater) Probes for Cygnus 4 GENERAL PURPOSE Gauges

(Please add Marinised Cable length as required for all Marinised Probe orders. Cable includes a Lemo 1 connector to connect with the gauge)

Marinised Probe S2C 2.25MHz 13mm	002-9387
Marinised Probe S2D 2.25MHz 19mm	002-9388
Marinised cable for use underwater priced per metre	001-0434
<i>(50m max. length for "S2-" (2.25MHz) probes, for other frequencies please contact Cygnus)</i>	

Accessories for Cygnus 4 GENERAL PURPOSE

Neck Strap with fixings for C2 / 2+ / 4 / 4+ / 6+ Mk5 UTG <i>(supplied as part of gauge kit)</i>	050-0115	
Hand Strap with fixing for C2 / 2+ / 4 / 4+ / 6+ Mk5 UTG	050-0110	
Belt Clip with fixing for C2 / 2+ / 4 / 4+ / 6+ Mk5 UTG	050-0100	
Peli Carry Case for Cygnus 2 / 2+ / 4 Mk5 UTG Gauge Kit	050-4010/5	

For Spare Leads see page 17 & for Spare Knurled Rings & Membranes page 18



Cygnus 4+ GENERAL PURPOSE

Multi-Mode Ultrasonic Thickness Gauge

All the benefits of the Cygnus 4, plus A-Scan display and sequential data logging as standard. A data logging upgrade is also available to add extra data logging functions. The gauge can be used in 3 measuring modes:

- * Multiple Echo with Single Crystal probes
- * Echo-Echo with Twin Crystal probes
- * Single Echo with Twin Crystal probes



Cygnus 4+ GENERAL PURPOSE Kit

Cygnus 4+ GENERAL PURPOSE Mk5 UTG Kit, without Probe

Contents: Ultrasonic Thickness Gauge - with sequential data logging - 3 x AA batteries - steel test block - ultrasonic & membrane couplant - accessory pouch - neck & wrist straps & fixings - SD card - CygLink software - mini USB to USB data cable - manual & carry case (The gauge has a Twin Lemo 00 connector)

Please select probe(s) & lead(s) from the lists below:

Order Code

050-4500/5



adds grid logging & radial points facility

#REF!

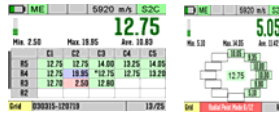

050-4520

Probes for Cygnus 4+ GENERAL PURPOSE Gauges

(All Probes are supplied with 20 membranes & membrane key)

Probe S2C Single 2.25MHz 13mm with BNC connector	004-9500
Probe S2D Single 2.25MHz 19mm with BNC connector	004-9502
Probe S3C Single 3.5MHz 13mm with BNC connector	004-9504
Probe S5C Single 5MHz 13mm with BNC connector	004-9508
lead for use with the above single crystal probes & a Cygnus 4+:	
Probe Lead Twin Lemo 00 to BNC 1.35m (4'6")	004-0410



Probe S5A Single 5MHz 6mm with Single Lemo 00 connector	004-9507
lead for use with the S5A probe & a Cygnus 4+:	
Probe Lead Twin Lemo 00 to Single Lemo 00 1.4m (4'6")	004-0412



Twin Crystal Probes for Cygnus 4+ GENERAL PURPOSE gauges

Probe T2C Twin 2MHz 12mm with Twin Lemo 00 connector	004-9550
Probe T5B Twin 5MHz 8mm (1/3") with Twin Lemo 00	004-9558
lead for use with the above twin crystal probes & a Cygnus 4+:	
Probe Lead Twin Lemo 00 to Twin Lemo 00 1.35m (4'6")	004-0411



Probe T5A Twin 5MHz 10mm (3/8") integral cable Twin Lemo 00	004-9560
Probe T7A Twin 7.5MHz 5mm 3/16" integral cable Twin Lemo 00	004-9575



4 Step Test Block for use with Twin Crystal Probes (non-discountable items)

Test Block Steel 4 Step Metric 2.5 - 20mm 2.5/5/10/20	001-4858
Test Block Steel 4 Step Imperial 0.1 - 0.75 inch	001-4859



Marinised (underwater) Probes for Cygnus 4+ HANDS FREE Gauges

Marinised Probe S2C 2.25MHz 13mm	002-9387
Marinised Probe S2D 2.25MHz 19mm	002-9388
Marinised cable for use underwater priced per metre	001-0434
(50m max. length for "S2-" (2.25MHz) probes, for other frequencies please contact Cygnus)	
Twin Lemo 00 to Single Lemo 1 adapter for C2+/C4+/C6+Mk5 UTG	050-0106
this adapter is required for using the above marinised probes with a "+" model Mk5 gauge	



Twin Lemo 00 to Single Lemo 1 adapter

Accessories for Cygnus 4+ GENERAL PURPOSE

Mini USB cable for data transfer (supplied as part of gauge kit)	050-0120
Neck Strap with fixings for C2 / 2+ / 4 / 4+ / 6+ Mk5 UTG (supplied as part of gauge kit)	050-0115
Hand Strap with fixing for C2 / 2+ / 4 / 4+ / 6+ Mk5 UTG (supplied as part of gauge kit)	050-0110
Belt Clip with fixing for C2 / 2+ / 4 / 4+ / 6+ Mk5 UTG	050-0100
Peli Carry Case for Cygnus 4+ Mk5 Gauge Kit	050-4511/5



For Spare Leads see page 17 & for Spare Knurled Rings & Membranes page 18



Cygnus 6+ PRO

Multi-Mode Ultrasonic Thickness Gauge

The Cygnus 6+ PRO has a front LED display plus an end mounted OLED display. It includes all the features of the 4+, plus comprehensive data logging, which includes grids, radial points & the facility to add bespoke templates. It has a B-Scan display. It also includes the option to choose manual gain control if required. The gauge can be connected to a computer either via the USB cable supplied or Bluetooth (please note the Bluetooth dongle is sold separately)



Cygnus 6+ PRO Kit

Cygnus 6+ PRO Mk5 UTG Kit, without Probe

Contents: Ultrasonic Thickness Gauge with comprehensive data logging - 3 x AA batteries, steel test block, ultrasonic & membrane couplant - accessory pouch - neck & wrist straps & fixings - SD card - CygLink software - mini USB to USB data cable - manual & carry case (The gauge has a Twin Lemo 00 connector)

Please select probe(s) & lead(s) from the lists below:

Order Code

050-6500/5



Probes for Cygnus 6+ PRO Gauges

(All Probes are supplied with 20 membranes & membrane key)

Probe S2C Single 2.25MHz 13mm with BNC connector	004-9500
Probe S2D Single 2.25MHz 19mm with BNC connector	004-9502
Probe S3C Single 3.5MHz 13mm with BNC connector	004-9504
Probe S5C Single 5MHz 13mm with BNC connector	004-9508



lead for use with the above single crystal probes & a Cygnus 6+:

Probe Lead Twin Lemo 00 to BNC 1.35m (4'6")	004-0410
---	----------

Probe S5A Single 5MHz 6mm with Single Lemo 00 connector	004-9507
---	----------

lead for use with the S5A probe & a Cygnus 6+:

Probe Lead Twin Lemo 00 to Single Lemo 00 1.4m (4'6")	004-0412
---	----------



Twin Crystal Probes for Cygnus 6+ PRO gauges

Probe T2C Twin 2MHz 12mm with Twin Lemo 00 connector	004-9550
Probe T5B Twin 5MHz 8mm (1/3") with Twin Lemo 00	004-9558



lead for use with the above twin crystal probes & a Cygnus 6+:

Probe Lead Twin Lemo 00 to Twin Lemo 00 1.35m (4'6")	004-0411
--	----------

Probe T5A Twin 5MHz 10mm (3/8") integral cable Twin Lemo 00	004-9560
Probe T7A Twin 7.5MHz 5mm 3/16" integral cable Twin Lemo 00	004-9575



4 Step Test Block for use with Twin Crystal Probes (non-discountable items)

Test Block Steel 4 Step Metric 2.5 - 20mm 2.5/5/10/20	001-4858
Test Block Steel 4 Step Imperial 0.1 - 0.75 inch	001-4859



Marinised (underwater) Probes for Cygnus 6+ HANDS FREE Gauges

Marinised Probe S2C 2.25MHz 13mm	002-9387
Marinised Probe S2D 2.25MHz 19mm	002-9388
Marinised cable for use underwater priced per metre	001-0434

(50m max. length for "S2-" (2.25MHz) probes, for other frequencies please contact Cygnus)

Twin Lemo 00 to Single Lemo 1 adapter for C2+/C4+/C6+Mk5 UTG	050-0106
--	----------

this adapter is required for using the above marinised probes with a "+" model Mk5 gauge

Accessories for Cygnus 6+ PRO

Mini USB cable for data transfer (supplied as part of gauge kit)	050-0120
Bluetooth Adapter V4.0 USB Belkin (not included in gauge kit - needs to be ordered if required)	050-0125
Neck Strap with fixings for C2 / 2+ / 4 / 4+ / 6+ Mk5 UTG (supplied as part of gauge kit)	050-0115
Hand Strap with fixing for C2 / 2+ / 4 / 4+ / 6+ Mk5 UTG (supplied as part of gauge kit)	050-0110
Belt Clip with fixing for C2 / 2+ / 4 / 4+ / 6+ Mk5 UTG	050-0100
Peli Carry Case for Cygnus 6+ Mk5 Gauge Kit	050-6511/5



For Spare Leads see page 17 & for Spare Knurled Rings & Membranes page 18



Cygnus 1 INTRINSICALLY SAFE ATEX

Multiple Echo Ultrasonic Thickness Gauge

A tough, ruggedised Ultrasonic Thickness Gauge (UTG) designed for safe use in potentially explosive environments. The Cygnus 1 INTRINSICALLY SAFE ATEX uses our Multiple Echo technology to take thickness measurements through protective coatings. It is supplied ready to use as a complete kit in a protective carry case with 2 rechargeable batteries.

ATEX Certification:

Group II Category 1G Ex ia IIC T6 Ga (Tamb = 0C to 45C)

Group I Category M1 Ex ia I Ma

Certificate No: BAS00ATEX1108

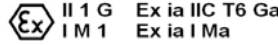

Nato Stock No: 5220-99-234-4651

Cygnus 1 INTRINSICALLY SAFE ATEX Kits

Cygnus 1 INTRINSICALLY SAFE ATEX Mk3 UTG Kit, without Probe

Contents: Ultrasonic Thickness Gauge - 2 rechargeable batteries - torque bar, ultrasonic & membrane couplant - 15mm/0.5" steel test block - battery charger - calibration jumper lead - trim tool - hex key - spare 'O'-rings - manual & carry case

Please select probe(s) from the list below:

Order Code

001-9921/3



Probes for Cygnus 1 INTRINSICALLY SAFE (IS) ATEX Gauges

(All Probes are supplied as nose cone assembly with 1 m cable, and with torque bar, 20 membranes and membrane key.)

Probe S2C 2.25MHz 13mm (1/2") for Cygnus 1 IS ATEX Mk3

001-9412-ATEX

Probe S2D 2.25MHz 19mm (3/4") for Cygnus 1 IS ATEX Mk3

001-9411-ATEX

Probe S3C 3.5MHz 13mm (1/2") for Cygnus 1 IS ATEX Mk3

001-9413-ATEX

Probe S5C 5MHz 13mm (1/2") for Cygnus 1 IS ATEX Mk 3 UTG

001-9344-ATEX

Probe S5A 5MHz 6mm (1/4") for Cygnus 1 IS ATEX Mk3 UTG

001-9345-ATEX



Right Angle Probes for Cygnus 1 INTRINSICALLY SAFE (IS) ATEX Gauges

(All Right Angle Probes are supplied as nose cone assembly with 1 m cable, and with torque bar, 20 membranes and membrane key.)

Right Angle Probe S2C 2.25MHz 13 mm for Cygnus 1 IS ATEX Mk3

001-9403

Right Angle Probe S5C 3.5MHz 13mm for Cygnus 1 IS ATEX Mk3

001-9405

Right Angle Probe S5A 5MHz 6mm for Cygnus 1 IS ATEX Mk3

001-9406

Right Angle Probe S5C 5MHz 13mm for Cygnus 1 IS ATEX Mk3

001-9407



General Spares for Cygnus 1 INTRINSICALLY SAFE (IS) ATEX

Battery for Cygnus 1 INTRINSICALLY SAFE ATEX Gauge Mk3

001-1505-ATEX

T6 Rated NiMH Battery for ATEX Gauges from Serial Number 3232. Supplied Uncharged.

Battery Charger for Cygnus UW / IS Mk3/4 (UK Mains Plug)

001-1514

Battery Charger for Cygnus UW / IS Mk3/4 (US Mains Plug)

001-1515

Battery Charger for Cygnus UW / IS Mk3/4 (EU Mains Plug)

001-1516

Calibration Jumper Lead for Cygnus 1 IS / UW / HD UTG

001-0410

Calibration Trim Tool

001-2600

1.5mm Hex Key for Cygnus 1 INTRINSICALLY SAFE UTG

001-2619

Nose Cone Torque Bar

001-2620

O Ring Pack for Cygnus 1 INTRINSICALLY SAFE UTG

001-3713

For Spare Knurled Rings & Membranes page 18

For Probes for Cygnus 1 INTRINSICALLY SAFE Mk 2 or Mk 1 (or below Serial No. 3232) page 21



Cygnus HEAVY DUTY

Multiple Echo Ultrasonic Thickness Gauge

A tough, ruggedised Ultrasonic Thickness Gauge (UTG) using Cygnus Multiple Echo technology, designed for use in demanding environments. The mechanical design of the Cygnus Heavy Duty has been proved and improved over nearly 30 years. This hardy and reliable tool is supplied ready to use as a complete kit in a protective carry case.



Nato Stock No: 5220-99-075-8576

Cygnus HEAVY DUTY Kits

Cygnus HEAVY DUTY Mk4 UTG Kit, without Probe

Order Code

001-9911/4

Contents: Ultrasonic Thickness Gauge - battery pack - torque bar - ultrasonic & membrane couplant - 15mm/0.5" steel test block - calibration jumper lead - spare 'O'-rings - manual & carry case

Please select probe(s) from the list below:



Probes for Cygnus HEAVY DUTY (HD) Gauges

(All Probes are supplied as nose cone assembly with 1 m cable, and with torque bar, 20 membranes and membrane key.)

Probe S2C 2.25MHz 13mm (1/2") for Cygnus HEAVY DUTY UTG

001-9330

Probe S2D 2.25 MHz 19mm (3/4") for Cygnus HEAVY DUTY UTG

001-9332

Probe S3C 3.5MHz 13mm (1/2") for Cygnus HEAVY DUTY UTG

001-9355

Probe S5C 5MHz 13 mm (1/2") for Cygnus HEAVY DUTY UTG

001-9334

Probe S5A 5MHz 6 mm (1/4") for Cygnus HEAVY DUTY UTG

001-9336



Right Angle Probes for Cygnus HEAVY DUTY (HD) Gauges

(All Right Angle Probes are supplied as nose cone assembly with 1 m cable, and with torque bar, 20 membranes and membrane key.)

Right Angle Probe S2C 2.25 MHz 13mm 1/2" for Cygnus HEAVY DUTY

001-9367

Right Angle Probe S3C 3.5MHz 13mm (1/2") for Cygnus HEAVY DUTY

001-9369

Right Angle Probe S5C 5MHz 13mm (1/2") for Cygnus HEAVY DUTY

001-9371

Right Angle Probe S5A 5MHz 6mm (1/4") for Cygnus HEAVY DUTY

001-9370



General Spares for Cygnus HEAVY DUTY (HD)

Battery Insert Plate (3 x AA) for Cygnus HEAVY DUTY Mk 3/4

001-3723

Battery Case (3 x AA) for Cygnus Heavy Duty (Mk3,4)

001-3722

Calibration Jumper Lead for Cygnus 1 IS / UW / HD UTG

001-0410

Calibration Trim Tool

001-2600

Nose Cone Torque Bar

001-2620

O Ring Pack for Cygnus Heavy Duty UTG

001-3718



For Spare Knurled Rings & Membranes page 18



Cygnus DIVE

Wrist-Mountable Underwater Thickness Gauge

The Cygnus DIVE, depth rated to 300 metres, is accurate, reliable and easy to use. The Cygnus DIVE is worn on the diver's forearm, availing an invaluable free hand while performing the thickness survey. A large, very bright colour AMOLED display shows the thickness measurements in big numbers along with a live A-scan for verification. Power is supplied by a replaceable, rechargeable, Lithium-Ion battery pack that gives up to 11 hours continuous measurement. The ultrasonic probe is connected by a coiled double jacket cable and rugged locking connector. Now with the option of Single Echo and Echo-Echo Modes for use with a Twin Crystal Probe, ideal for use on extremely heavy corrosion & anchor chain. Single Echo is for use on un-coated surfaces and Echo-Echo for use through paint up to 0.5mm thick. An optional data logging feature is available for storing up to 5000 measurements and A-Scans. CygLink v4. provides surface computer based viewing and data logging. The Topside Repeater unit with Video On-Screen Display option allows the thickness measurements to be overlaid onto the monitor screen / video recording of the survey. HelmetView provides a helmet-mounted remote display of thickness measurements.

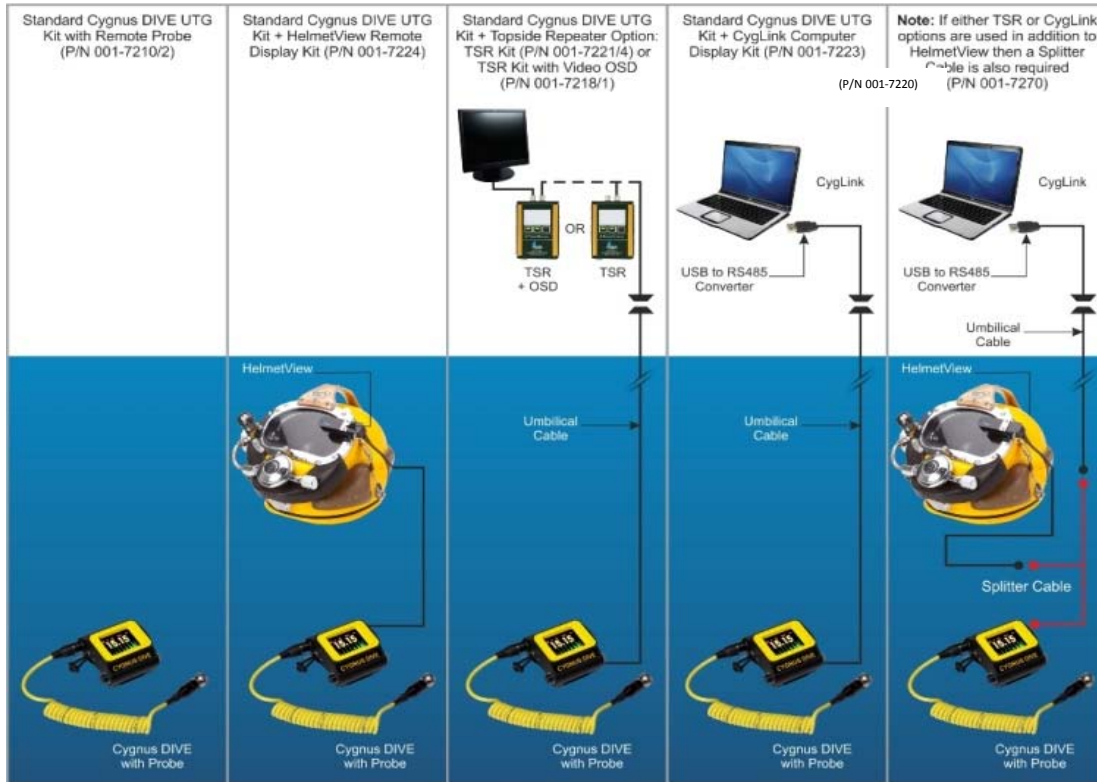

Cygnus DIVE Kits (see next page for Topside Kit options)

<p>Cygnus DIVE Mk2 UTG Kit, without Probe <i>Contents: Ultrasonic Thickness Gauge - 2 rechargeable batteries & charger - screen protector- silicone grease - lanyard - ultrasonic & membrane couplant - 15mm/0.5" steel test block - manual & carry case</i> Please select probe(s) & lead(s) from the lists below:</p>	<p>Order Code 001-7200/2</p>
--	----------------------------------

<p>Cygnus Data Logging DIVE Mk2 UTG Kit, without Probe <i>Contents: Ultrasonic Thickness Gauge - CygLink software on USB flash drive - Umbilical (9-way D) to PC (USB) link lead - DIVE (Fischer) direct to PC (USB) lead - 2 rechargeable batteries & charger - screen protector, silicone grease - lanyard - spare membranes - membrane key - ultrasonic & membrane couplant - 15mm/0.5" steel test block - manual & carry case</i> Please select probe(s) & lead(s) from the lists below:</p>	<p>001-7201/2</p>
---	-------------------

Single Crystal Probes for Cygnus DIVE Gauge (Multiple Echo Mode)

(All Single Crystal Probes have integral coiled double-jacket cable and rugged locking connector, and are supplied with membrane key and a pack of 20 membranes.)

<p>Probe S2C Single Crystal 2.25MHz 13mm 1/2" for Cygnus DIVE UTG</p>	<p>001-7230</p>
<p>Probe S3C Single Crystal 3.5MHz 13mm 1/2" for Cygnus DIVE UTG</p>	<p>001-7231</p>
<p>Probe S5C Single Crystal 5MHz 13mm 1/2" for Cygnus DIVE UTG</p>	<p>001-7232</p>
<p>Probe S5A Single Crystal 5MHz 6mm (1/4") for Cygnus DIVE UTG</p>	<p>001-7233</p>

Twin Crystal Probe for Cygnus DIVE Gauge (Single Echo & Echo-Echo Modes)

(All Twin Crystal Probes have integral coiled double-jacket cable and rugged locking connector)

<p>Probe T5B Twin Crystal 5MHz 8mm for DIVE Mk2 UTG</p>	<p>001-7235</p>
<p>Probe T2C Twin Crystal 2MHz 12mm for Cygnus DIVE Mk2 UTG</p>	<p>001-7236</p>



Cygnus DIVE

Wrist-Mountable Underwater Thickness Gauge

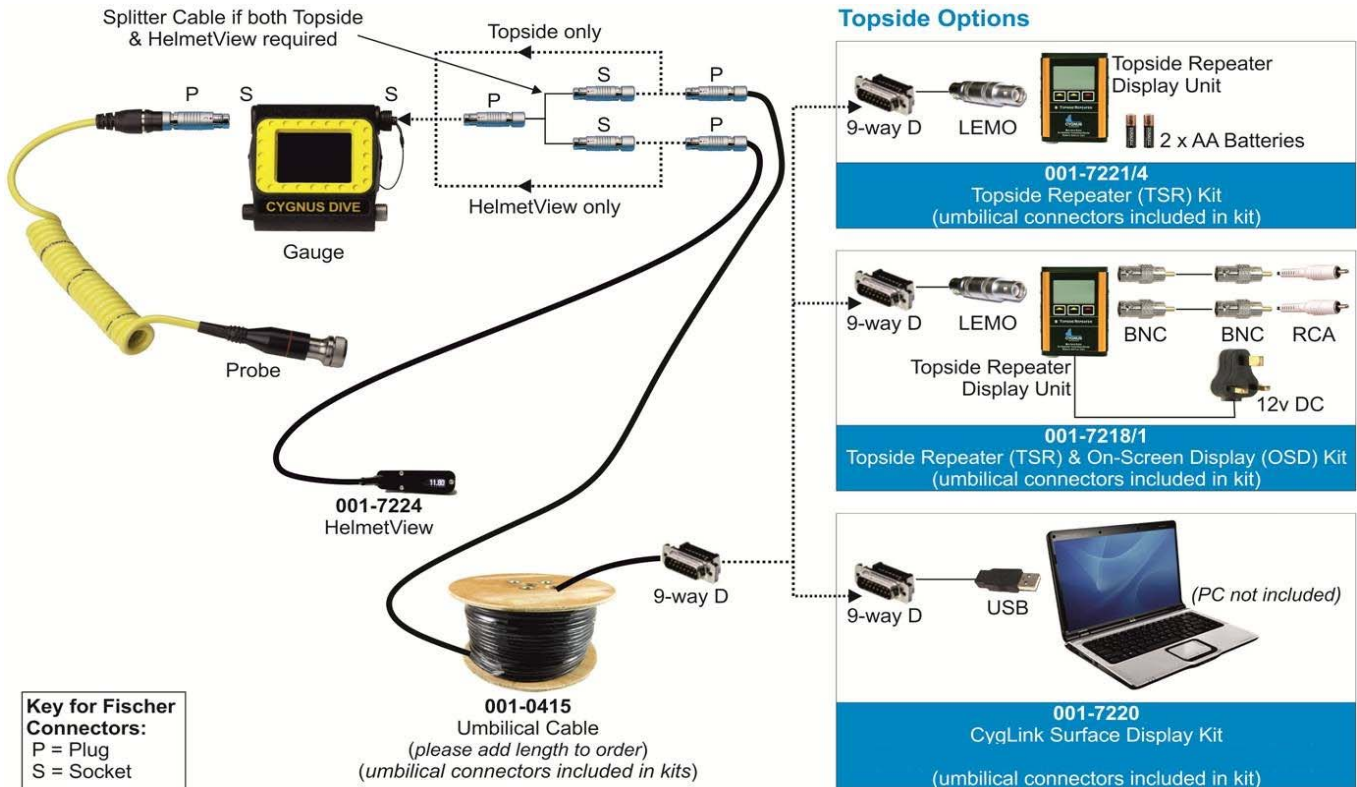

Surface/Topside Display Options for Cygnus DIVE Mk2 Gauge

Order Code

Topside Repeater (TSR) Kit for Cygnus DIVE UTG

001-7221/4

Upgrade Kit for Cygnus DIVE, to add Topside Repeater (TSR) Display Unit

Kit contents:

Cygnus Topside Repeater display unit - Silicone sleeve - Umbilical (9-way D) to TSR (Lemo) link lead - Cygnus DIVE (Fischer) to (9-way D) topside umbilical connectors - 2 x AA batteries

Please add to order: Umbilical cable (001-0415) & specify length

Topside Repeater (TSR) Kit with Video OSD for Cygnus DIVE

001-7218/1

Upgrade Kit for Cygnus DIVE to add Topside Repeater (TSR) Display Unit with Video On-Screen Display (OSD)

Contents: Cygnus Topside Repeater display unit - Silicone sleeve - Umbilical (9-way D) to TSR (Lemo) link lead - Cygnus DIVE (Fischer) to (9-way D) topside umbilical connectors - 2 BNC cables with RCA phono adapters - DC power supply 12 V universal plug-in

Please add to order: Umbilical cable (001-0415) & specify length

Surface Computer Logging feature for Cygnus DIVE UTG

001-7220

Upgrade Kit for Cygnus DIVE to add CygLink Surface Computer Display with Computer Data Logging Facility

Contents: Umbilical (9-way D) to computer (USB) link lead & Cygnus DIVE (Fischer) to (9-way D) topside umbilical connectors
 CygLink software on USB

Please add to order: Umbilical cable (001-0415) & specify length

Umbilical cable for DIVE / UW / ROV to Topside (per metre)

001-0415

supplied with Umbilical (9-way D) to PC (USB) Link Lead for CygLink



Cygnus DIVE

Wrist-Mountable Underwater Thickness Gauge

HelmetView for Cygnus DIVE Gauge

Order Code



HelmetView MK2 Remote Display Kit for Cygnus DIVE UTG

001-7224/2

An OLED display, integrated link lead to Cygnus DIVE (Fischer) & mounting brackets for Kirby Morgan helmets to display the thickness measurement in front of a diver's lens

(Suitable for use with DIVE Mk1 (orange gauge))

Splitter Cable for Cygnus DIVE HelmetView & Surface Display

001-7270

Splitter (Y) cable that enables both HelmetView (Fischer) & an umbilical cable (Fischer) for Topside display options to be connected to the Cygnus DIVE gauge (Fischer)

General Spares for Cygnus DIVE

CygLink Data Logging software upgrade for Cygnus DIVE

001-7219/2

Upgrade Kit for Cygnus DIVE Mk2 Ultrasonic Thickness Gauge (UTG) to add Data Logging Facility

Kit contents: Cygnus CygLink Software on USB Flash Drive - Cygnus DIVE Data Logger to USB Lead - Software Enabler Key (on USB Flash Drive)

Cygnus DIVE (Fischer) direct to computer (USB) Link Lead

001-7271

Umbilical (9-way D) to PC (USB) Link Lead for CygLink

001-7262

Umbilical (9-way D) to TSR Display Unit (Lemo) Link Lead

001-0426

Video Cables and Adapters for Topside Repeater with OSD

001-0442

Cygnus DIVE (Fischer)-(9-way D) topside umbilical connectors

001-7260

Cygnus DIVE UTG Battery, uncharged (Watt Hour Rating: 8.1Wh)

001-7250

Battery Charger for Cygnus DIVE UTG (UK Mains Plug)

001-7251-UK

Battery Charger for Cygnus DIVE UTG (EU Mains Plug)

001-7251-EU

Battery Charger for Cygnus DIVE UTG (US Mains Plug)

001-7251-US

Screen Protector for Cygnus DIVE UTG

001-7263

Replacement Lanyard for Cygnus DIVE UTG

001-7257

Operation Manual for Cygnus DIVE Mk2 UTG Printed A5

001-7256/2



Cygnus UNDERWATER

Diver-Held Underwater Thickness Gauge

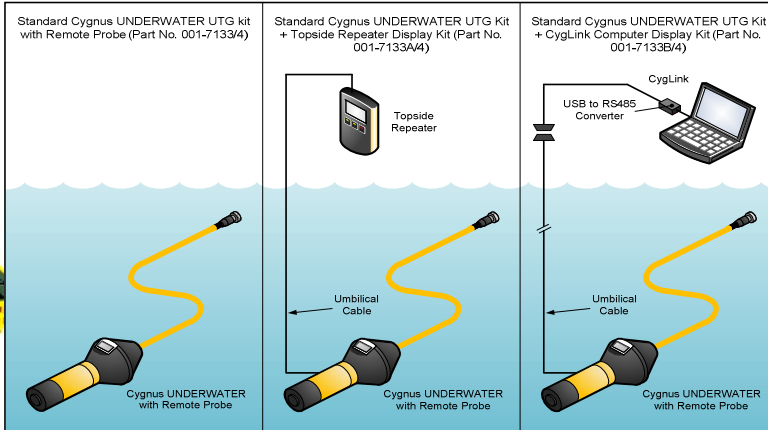

A tough underwater Ultrasonic Thickness Gauge (UTG) using our Multiple Echo technology, designed for divers undertaking subsea surveys. Pressure tested to 300 m depth and supplied ready to use as a complete kit in a protective carry case with 2 rechargeable batteries.

Cygnus UNDERWATER Kits

Cygnus UNDERWATER Mk4 UTG Kit, without Probe

Order Code

001-9933/4

Contents: Ultrasonic Thickness Gauge - 2 rechargeable batteries - torque bar - membrane couplant - steel test block - lanyard - battery charger - calibration jumper lead - silicone grease - spare probe knurled ring & gauge 'O'-rings - operation manual & carry case

Please select probe(s) from the list below:

Probes for Cygnus UNDERWATER Gauges

(All Probes are supplied as nose cone assembly with 1 m cable, and with torque bar, 20 membranes and membrane key.)

Probe S2C 2.25MHz 13mm (1/2") for Cygnus Underwater/MINI ROV

001-9340

Probe S2D 2.25MHz 19mm (3/4") for Cygnus Underwater UTG

001-9341

Probe S3C 3.5MHz 13mm (1/2") for Cygnus Underwater UTG

001-9357



Surface/Topside Display Options

Upgrade Kit A for Cygnus UW to add Topside Repeater Unit (TSR)

001-7133A

for Cygnus UNDERWATER Ultrasonic Thickness Gauge with Topside Connector

Contents: Cygnus Topside Repeater (TSR) display unit - 2 AA batteries - silicone sleeve - Cygnus UNDERWATER (4-way Impulse) to TSR (Lemo 1) data connection

(Please add to order: Umbilical cable (001-0415) & specify length)



Upgrade Kit B (CygLink) for Cygnus UW to add surface computer logging

001-7133B

for Cygnus UNDERWATER Ultrasonic Thickness Gauge with Impulse connector

Contents: CygLink software, Cygnus UNDERWATER (4-way Impulse) to Topside (9-way D RS422) data connection, Isolated data converter (RS422/RS485 to USB)

(Please add umbilical cable (001-0415) & specify length)



Umbilical cable for DIVE / UW / ROV to Topside (per metre)

001-0415

supplied with Umbilical (9-way D) to PC (USB) Link Lead for CygLink

General Spares

Battery for Cygnus UNDERWATER Gauges Mk3/4 (Uncharged)

001-1504

Battery Charger for Cygnus UW / IS Mk3/4 (UK Mains Plug)

001-1514

Battery Charger for Cygnus UW / IS Mk3/4 (US Mains Plug)

001-1515

Battery Charger for Cygnus UW / IS Mk3/4 (EU Mains Plug)

001-1516

Calibration Jumper Lead for Cygnus 1 IS / UW / HD UTG

001-0410

'O' Ring Pack for Cygnus UNDERWATER UTG

001-3711

Contents: 20 sets of 'O' Ring A - 40 sets of 'O' Ring B/D - 20 sets of 'O' Ring C

Spares Kit for Cygnus UNDERWATER UTG

001-3715

Contents: 'O'-rings (3 types: 20 x A - 40 x B - 20 x C) - silicone grease - 20 polyurethane membranes & 1 membrane key for each probe size (6mm - 13mm & 19mm) & membrane couplant

Impulse Connector 4-Way with Flying Lead

001-0418

Impulse Connector 4-Way Blanking Plug

001-0419

Connectors for umbilical UW UTG (Impulse) to TSR (Lemo)

001-0414

Connectors for umbilical Cygnus UW UTG (Impulse) to PC (9D)

001-0413

Isolated Data Converter (RS422/RS485 to USB)

001-8305

Topside Interface Cable A (Lemo socket) to B (9-way D plug)

001-0416

Topside Interface Cable B (9-way D socket) to A (Lemo plug)

001-0417

CygLink Software and Underwater Gauge Manual on USB stick

001-8210

Lanyard for Cygnus UNDERWATER UTG

001-4822

For Spare Knurled Rings & Membranes page 18



Cygnus ROV MOUNTABLE 2/4 km

Multiple Echo Ultrasonic Thickness Gauges

Available in 2000 m and 4000 m depth rated housings, these units are truly versatile and designed to operate in the harshest deepsea operating conditions. Dedicated software displays the time, date and thickness measurements on the surface which can be stored or logged. Alternatively, an optional Topside Repeater is available which has the facility to display readings remotely and overlay them onto a video signal which allows the measurements to be superimposed on the ROV camera's monitor screen.

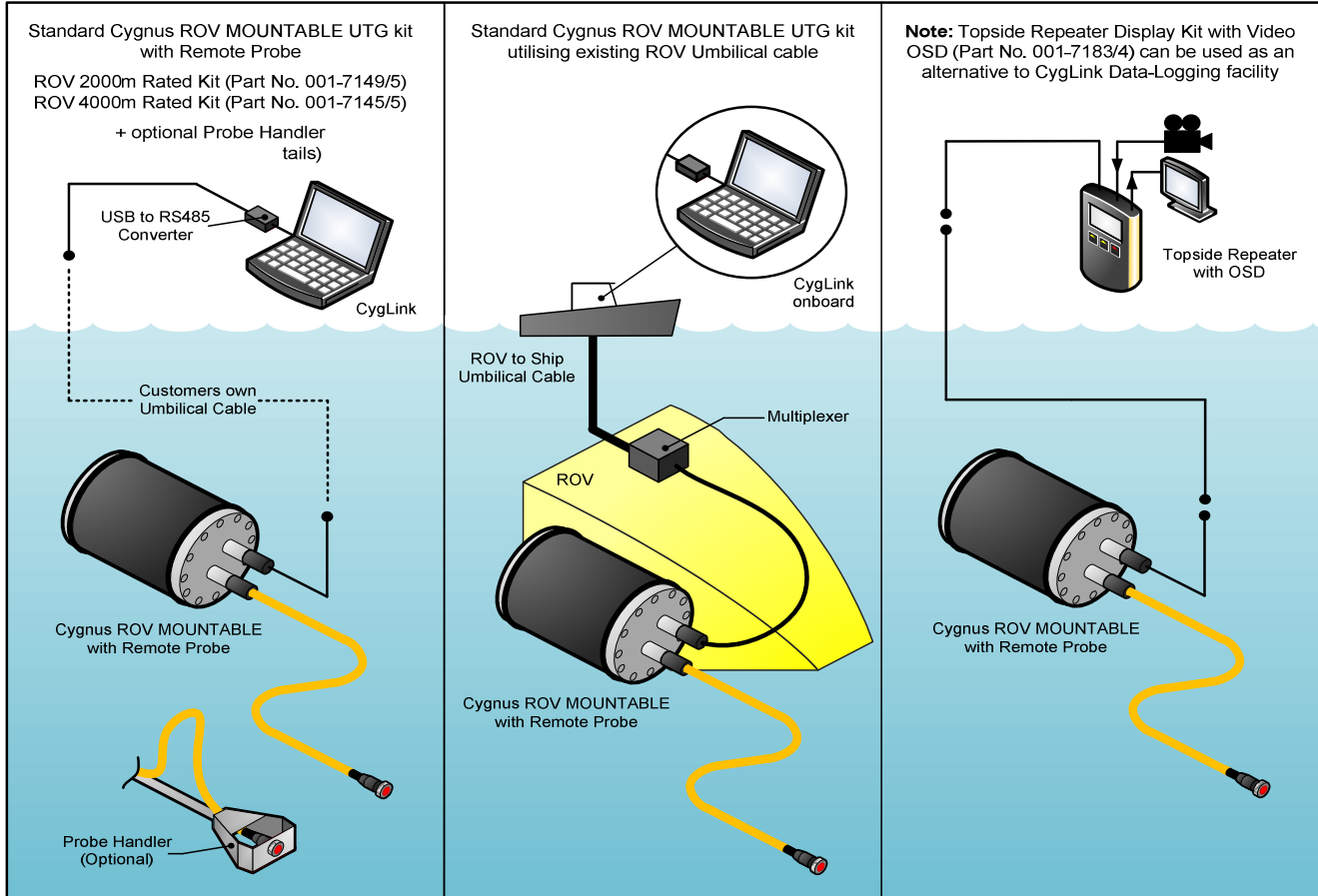

Cygnus ROV MOUNTABLE 2000 m / 4000 m Kits

Cygnus ROV 2000m Mk5 UTG Kit, without Probe

Order Code

001-9949/5

Contents: Ultrasonic Thickness Gauge - power & data test cable - gauge (Subconn) to umbilical (flying) lead - 9-way D connector - 'K3' RS422 to RS232 converter - RS232 to USB serial interface cable - Cyglink data logging software - spare 1A fuses - 3 mm allen key - silicone grease - spare 'O'-rings - ultrasonic & membrane couplant - steel test block - manual & carry case

Please select probe(s) from the list below:

Cygnus ROV 4000m Mk5 UTG Kit, without Probe

001-9945/5

Contents: Ultrasonic Thickness Gauge - power & data test cable - gauge (Subconn) to umbilical (flying) lead - 9-way D connector - 'K3' RS422 to RS232 converter - RS422/RS485 to USB converter - Cyglink data logging software - spare 1A fuses - 3 mm allen key - silicone grease - spare 'O'-rings - 20 membranes - membrane key - ultrasonic & membrane couplant - steel test block - manual & carry case

Please select probe(s) from the list below:

Probes for Cygnus ROV MOUNTABLE 2000 m / 4000 m Gauges

(All Probes are supplied with 5 m cable (unless otherwise customised) and with 20 membranes and membrane key.)

Probe S2C 2.25MHz 13mm for Cygnus ROV 2/4km Mk5 - 5m cable

001-9393

Probe S2C 2.25MHz 13mm for Cygnus ROV 2/4km Mk5 - cust length

001-9394

Probe S2D 2.25MHz 19mm for Cygnus ROV 2/4km Mk5 - 5m cable

001-9395



For Probes to fit Cygnus ROV Probe Handlers see next page



Cygnus ROV MOUNTABLE 2/4 km

Multiple Echo Ultrasonic Thickness Gauges

Surface/Topside Display Option for Cygnus ROV MOUNTABLE Gauges

Order Code

Topside Repeater (TSR) Kit with Video OSD for ROV 2000/4000m

001-7183/4



Contents: Topside Repeater Surface Display Unit with On-Screen Video Overlay Facility - BNC Video Leads and RCA Connectors - 12 VDC Power Supply (UK/US/EUR) - one set of Umbilical Connectors with Tails & Silicone Sleeve. On-Screen Video Overlay is suitable for connecting into composite video feeds (PAL or NTSC)

Cygnus ROV Probe Handlers

G1 Inspection ROV PROBE HANDLER without Probe

001-8351



Cygnus S1 Hull Inspection ROV PROBE HANDLER, without Probe

001-8331



Cygnus W1 Work Class ROV PROBE HANDLER, less Probe & Handle

001-8311

Fishtail Manipulator Handle

001-8316

3/4" T-Bar Manipulator Handle

001-8314

1/2" T-Bar Manipulator Handle

001-8315



Probes for Cygnus ROV Probe Handlers

#REF!

001-8364

#REF!

001-8355

#REF!

001-8335

General Spares for Cygnus ROV MOUNTABLE 2000 m / 4000 m Gauges

RS232 to USB Serial interface cable

003-0422

Isolated Data Converter RS422 to RS232 Model K3

001-8308

CygLink Topside Data Logging Software for Cygnus Mk5 ROV's

003-8213

Video Cables and Adapters for Topside Repeater with OSD

001-0442

Power & Data Connector for 2000/4000m ROV with flying lead

001-0431

Data Test & Power Cable RS232/422 for 2000/4000M ROV UTG

001-0439

Umbilical cable for DIVE / UW / ROV to Topside (per metre)

001-0415

Umbilical cable connectors for ROV 2000/4000m UTG to laptop

001-7185

Umbilical cable connectors for ROV 2000/4000m UTG to TSR

001-7186

Spares Kit for Cygnus ROV Mountable 2000m/4000m UTG

001-3719



For Spare Knurled Rings & Membranes page 18



Cygnus MINI ROV MOUNTABLE

Multiple Echo Ultrasonic Thickness Gauge

The Cygnus MINI ROV Mountable ultrasonic thickness gauge (UTG) is designed to be mounted onto small, observation ROVs, with or without a manipulator facility. Dedicated software displays the time, date and thickness readings on the surface which can all be logged. Alternatively, an optional Topside Repeater (TSR) display unit is available, which has the facility to display measurements remotely and overlay them onto a video signal. Therefore measurements can be superimposed on the ROV camera's monitor screen.



Cygnus MINI ROV Mountable Kits (Pressure tested to 500 m)

Cygnus MINI ROV 500m Mk4 UTG Kit without Probe

Order Code

001-9944/4

Contents: Ultrasonic Thickness Gauge - power and data test cable - gauge (4-way 'Impulse' connector) to umbilical (flying) lead - 'Impulse' blanking plug - 9-way D connector, K3' RS422 to RS232 converter - RS232 to USB Serial interface cable - CygLink data logging software - silicone grease - spare 'O'-rings - torque bar - ultrasonic & membrane couplant - 15mm/0.5" steel test block - manual & carry case

Please select probe(s) from the list below:

Probes for Cygnus MINI ROV Mountable Gauge

(All Probes are supplied as nose cone assembly with 1 m cable, and with torque bar, 20 membranes and membrane key.)

Probe S2C 2.25MHz 13mm (1/2") for Cygnus Underwater/MINI ROV
 Probe S2D 2.25MHz 19mm for Cygnus MINI ROV MOUNTABLE UTG

001-9340

003-9410



Cygnus ROV Probe Handlers and Probes

G1 Inspection ROV PROBE HANDLER without Probe
 Probe S2C 2.25MHz 13mm (1/2") for G1 & MINI ROV UTG (1m cable)
 Cygnus S1 Hull Inspection ROV PROBE HANDLER, without Probe
 Probe S2C 2.25MHz 13mm (1/2") for S1 & MINI ROV UTG (1m cable)

001-8351

001-8354

001-8331

001-8334

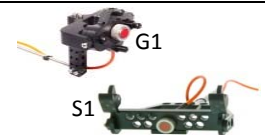

Surface/Topside Display Option for Cygnus MINI ROV Mountable Gauge

Topside Repeater Kit with Video OSD for Cygnus MINI ROV UTG

001-7153/4

Contents: Topside Repeater Surface Display Unit with On-Screen Video Overlay Facility - BNC Video Leads & RCA Connectors - 12 VDC Power Supply (UK/US/EUR) - Lemo to 9way D Connection Lead & Silicone Sleeve. On-Screen Video Overlay is suitable for connecting into composite video feeds (PAL or NTSC)



VideoRay Fittings for Cygnus MINI ROV Mountable Gauge

VideoRay Mounting Kit incl. brackets, fittings, cable

001-8309

for use with Cygnus MINI ROV includes: mounting brackets - fittings & connection cable (4-way Impulse to 9-way SubConn) (Skids not included)

General Spares for Cygnus MINI ROV Mountable Gauge

O Ring Pack for Cygnus MINI/1000m /3000m ROV Mountable UTG

001-3712

Kit contents: 20 x 'O'-ring type A and 20 x 'O'-ring type B.

RS232 to USB Serial interface cable

003-0422

Isolated Data Converter RS422 to RS232 Model K3

001-8308

CygLink Software & manual on USB for MINI ROV UTG

001-8333

Impulse Connector 4-Way Blanking Plug

001-0419

Impulse Connector 4-Way with Flying Lead

001-0418

Test Cable - Impulse to 9 way 'D' Connector with DC Power

001-0432

Video Cables and Adapters for Topside Repeater with OSD

001-0442

Umbilical cable for DIVE / UW / ROV to Topside (per metre)

001-0415

Umbilical cable connectors for Cygnus MINI ROV UTG

001-7154



For Spare Knurled Rings & Membranes page 18



Cygnus Probes





for use with Cygnus Ultrasonic Thickness

Single Crystal Probes for use with gauges in Multiple Echo Mode:

Probe Type	Band Colour	Frequency	Crystal Size \varnothing	Measuring Range in Steel	Probe Connectors	
S2C	Red	2.25 MHz	13mm / 0.512"	3 - 250mm / 0.118" - 9.842"	BNC	
S3C	Orange	3.5MHz	13mm / 0.512"	2 - 150mm / 0.078" - 5.905"		
S5C	Black	5.0 MHz	13mm / 0.512"	1 - 50mm / 0.039" - 1.968"		
S5A	Black	5.0 MHz	6mm / 0.236"	1 - 50mm / 0.039" - 1.968"	Lemo 00	
S2D	Red	2.25 MHz	19mm / 0.748"	3 - 250mm / 0.118" - 9.842"	BNC	

Suitable for surface temperatures up to 75°C (167°F) with standard membranes & 150°C (302°F) with Teflon membranes, please see page 19 for membrane details

Twin Crystal Probes for use in Echo-Echo & Single Echo Modes:

Probe Type	Frequency	Crystal Size \varnothing	Contact Size \varnothing	Measuring Range in Steel in Single Echo	Measuring Range in Steel in Echo-Echo	Probe connectors	
T2C	2 MHz	12mm	17mm / 0.66"	2.5 - 200mm 0.12 - 8"	5 - 50mm 0.2 - 2"	Twin Lemo 00	
T5B	5 MHz	8mm	13mm / 0.5"	1 - 200mm 0.39 - 7.9"	3 - 50mm 0.16 - 2"	Twin Lemo 00	
T5A	5 MHz	5mm	10mm / 0.39"	1 - 150mm 0.39 - 6"	3 - 50mm 0.12 - 2"	Integral cable	
T7A	7.5 MHz	5mm	7mm / 0.27"	0.8 - 50mm 0.03 - 2"	3 - 25mm 0.12 - 1"	Integral cable	

Suitable for use on surface temperatures up to 60°C (140°F)

Probe Type reference key:

First Letter Single or Twin	Middle Number Frequency in MHz	Last Letter Crystal Size \varnothing
S = Single T = Twin	2 = 2 MHz / 2.25 MHz 3 = 3.5 MHz 5 = 5 MHz 7 = 7.5MHz	A = 5-6mm / 0.2-0.236" B = 8mm / 0.314" C = 13mm / 0.512" D = 19mm / 0.748"



Cygnus Probe Leads

for use with Cygnus Ultrasonic Thickness Gauges



Leads for use with Cygnus 2 & 4 Mk5 & Cygnus 3 Mk4 Gauges

	<i>Order Code</i>
Probe Lead Lemo 1 - BNC 1.4m (4'6")	004-0406
Probe Lead Twin Lemo 00 to BNC 1.35m (4'6")	004-0410
Probe Lead Single Lemo 1 - Single Lemo 00 1.35 m (4'6")	004-0401
Probe Lead RG58 Lemo 1S to BNC 1.35m (4'6")	004-0405

Leads for use with Cygnus 2+ & 4+ Mk5 Gauges

Probe Lead Twin Lemo 00 to Twin Lemo 00 1.35m (4'6")	004-0411
Probe Lead Twin Lemo 00 to BNC 1.35m (4'6")	004-0410
Probe Lead Twin Lemo 00 to Single Lemo 00 1.4m (4'6")	004-0412



Cygnus Membranes & Knurled Rings (spares)

for use with Cygnus Single-Crystal Ultrasonic Probes

All Cygnus single-crystal probes are constructed from stainless steel and incorporate a replaceable wear membrane to protect the probe face. The performance of the probe depends on the condition of the membrane and how well it has been fitted. Please refer to your Operation Manual for guidelines on changing the protective membrane on Cygnus Probes.

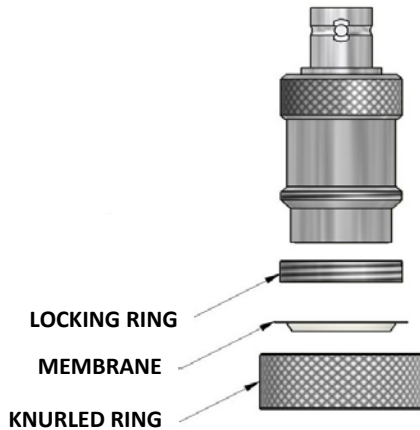

Important note: the actual Membrane Diameter is larger than the "Probe Size" that it is designed to fit. The "Probe Size" is defined by the diameter of the black part of the Probe Face. Please order membranes according to "Probe Size" as per the below table:

Probe size	Size of head including Knurled Ring (approx.)	Physical size of membrane (approx.)
6mm	18mm	14mm
13mm	24mm	21mm
19mm	30mm	28.5mm

Standard Membranes

(Standard membranes are made of polyurethane and are suitable for surface temperatures up to 75°C (167°F). Available in packs of 20.)

Polyurethane Membranes for 19 mm (3/4") Probes - pack of 20
 Polyurethane Membranes for 13 mm (1/2") Probes - pack of 20
 Polyurethane Membranes for 6 mm (1/4") Probes - Pack of 20

Order Code	Membrane Diameter	To fit "Probe Size"
001-3700	21 mm	19 mm Probe
001-3701	19 mm	13 mm Probe
001-3702	13 mm	6 mm Probe

Higher Temperature Membranes

(Higher temperature membranes are made of Teflon and are suitable for surface temperatures up to 150°C (302°F), with a maximum contact time of 5 seconds. Available in packs of 10.)

Teflon Membranes for 19 mm (3/4") Probes - pack of 10
 Teflon Membranes for 13 mm (1/2") Probes - pack of 10
 Teflon Membranes for 6 mm (1/4") Probes - pack of 10

Order Code	Membrane Diameter	Probe Size
001-4875	21 mm	19 mm Probe
001-4874	19 mm	13 mm Probe
001-4873	13 mm	6 mm Probe

Knurled Rings and Membrane (or Locking Ring) Keys

Knurled Ring Assembly for 19 mm (3/4") Probes
 Knurled Ring Assembly for 13 mm (1/2") INOX Probes
 Knurled Ring Assembly for 13 mm (1/2") Probes
 Knurled Ring Assembly for 6 mm (1/4") Probes
 Membrane Key for 19 mm (3/4") Probes
 Membrane Key for 13 mm (1/2") Probes
 Membrane Key for 6 mm (1/4") Probes

001-3705
001-3709
001-3704
001-3703
001-2610
001-2611
001-2612

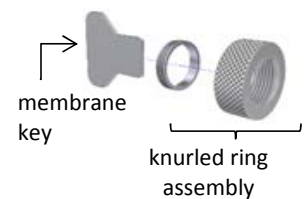

Cygnus Accessories

Couplant

	Order Code
Couplant UCA-2M (1 litre tub)	001-3707
Couplant UltraSonix High Performance Gel (118ml)	001-3708
Membrane Couplant 25 ml bottle	001-3706



Membrane couplant

Grease for use with UNDERWATER & DIVE Gauges

Silicone Grease 50g Tube	001-4861
--------------------------	----------

Test Blocks

Steel Test Block 15 mm <i>(not supplied with a calibration certificate)</i>	001-4850
Steel Test Block 1/2" <i>(not supplied with a calibration certificate)</i>	001-4851
Test Block Stainless Steel 15 mm <i>(not supplied with a calibration certificate)</i>	001-4854
Test Block Aluminium 15 mm <i>(not supplied with a calibration certificate)</i>	001-4857
3 Area Coated Test Block <i>(Non discountable item) (not supplied with a calibration certificate)</i>	001-4887
Test Block Steel 4 Step Metric 2.5 - 20mm 2.5/5/10/20 <i>(Non discountable item) (not supplied with a calibration certificate)</i>	001-4858
Test Block Steel 4 Step Imperial 0.1 - 0.75 inch <i>(Non discountable item) (not supplied with a calibration certificate)</i>	001-4859
Calibration Block - Steel 4 Step Imperial 0.1-0.75" <i>(Non discountable item) Traceable calibration certificate supplied</i>	001-4876
Calibration Block - Steel 4 Step Imperial 0.1" - 0.75" <i>(Non discountable item) Traceable calibration certificate supplied</i>	001-4877
Calibration Block Carbon Steel 5-25 mm 5 mm steps in perspex <i>(Supplied with dimensional and material type certificate.)</i>	001-4856

3 Area Coated Test Block



4 Step Test Block



Carbon Steel Step Block & 15mm Test

Pit Gauges

Cygnus Mechanical Pit Gauge <i>(Measurement Range: 0 to 43 mm)</i>	111-7165
---	----------



Pit Gauge

Surface Preparation Accessories

Chipping/Boiler Scaling Hammer 1lb Ash Handle	500-0100
Carbide Edged Power Scraper	500-0101
Steel Wire Brush & Scraper	500-0102

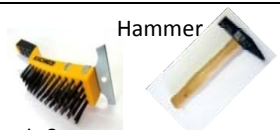

Hammer

Brush & Scraper

Cygnus Manuals

Cygnus Gauge manuals are available to download from the support section of our website, if the manual you require is not available for any reason please contact us on sales@cygnus-instruments.com and we will be happy to email it. Paper copies are available for £8.00 plus carriage



Carry Cases & Gauge Bodies for current range

Carry cases, pouches, sleeves, slings & straps

Order Code

for Surface Thickness Gauges

Soft Carry Case + foam for C2 / 2+ / 4 / 4+ / 6+ Mk5 UTG Kit	050-0105
2x Neck Strap fixings for C2 / 2+ / 4 / 4+ / 6+ Mk5 UTG	050-0116
Soft Carry case & foam for Cygnus 2 / 3 / 4 Mk4 UTG	002-4838
Silicone Sleeve for Cygnus 4 GENERAL PURPOSE Mk4 or TSR	004-4835
Belt Clip for Silicone Sleeve for Cygnus 2 / 3 / 4 Mk4 UTG	002-4836/4
Fabric Accessories Pouch	002-4837/4
Hard Carry Case for Cygnus 1 IS & HD UTG Kits	001-4800
Peli Carry Case for Cygnus 2 / 2+ / 4 Mk5 UTG Gauge Kit	050-4010/5
Peli Carry Case for Cygnus 4+ Mk5 Gauge Kit	050-4511/5
Peli Carry Case for Cygnus 6+ Mk5 Gauge Kit	050-6511/5

for Subsea Thickness Gauges

Peli Carry Case for Cygnus DIVE MK2 UTG (Yellow)	001-7252/2
Peli Carry Case for Cygnus UNDERWATER UTG Kit (Yellow)	001-4813-UW
Peli Carry Case for Cygnus ROV UTG Kit (Yellow)	001-4813-ROV

for Hatch Sure

Ruck sack style soft carry case for Hatch Sure Mk1 Kit	006-1009
Protective Pouch with Sling for Hatch Sure Mk1 Transmitter	006-1011
Protective Pouch for Hatch Sure Mk1 Receiver	006-1014
Waist Strap for Cygnus Hatch Sure Mk1 Receiver	006-1015

Gauge Bodies (latest electronics available only)

Cygnus 2 HANDS FREE Mk5 UTG body only	050-2011/5
Cygnus 2+ HANDS FREE Mk5 UTG body only	050-2015/5
Cygnus 3 DATA LOGGER Gauge Body only	003-7177/4
Cygnus 4 GENERAL PURPOSE Mk5 UTG body only	050-4011/5
Cygnus 4+ GENERAL PURPOSE Mk5 UTG body only	050-4015/5
Cygnus 6+ PRO Mk5 UTG body only	050-6011/5
Cygnus 1 INTRINSICALLY SAFE CSA UTG Body only	001-7171-CSA/3
Cygnus 1 INTRINSICALLY SAFE ATEX UTG Body only	001-7171-ATEX/3
Cygnus DIVE UTG Mk2 Body only	001-7255/2
Cygnus DIVE Data Logging Mk2 UTG Body only	001-7259/2
Cygnus UNDERWATER Gauge Body only with Topside Connector	001-7179/4
Topside Repeater (Repeater Body only)	001-7181/4
Topside Repeater with Video OSD (Repeater Body only)	001-7182/4
Cygnus HEAVY DUTY UTG Body only	001-7170/4
Cygnus ROV Mountable 2000m UTG Body only	001-7189/5
Cygnus ROV Mountable 4000m UTG Body only	001-7191/5
Cygnus MINI ROV Mountable UTG Body only	001-7190/4



Spares for previous models

Probe Leads for Cygnus 2, 3 & 4 Mk 2/3

Order Code

Probe Lead RG58 Lemo 00 to BNC (1.35m 4'6")	001-0402
Probe Lead RG58 Lemo 00 to Lemo 00 (1.35m 4'6")	001-0400
Probe Lead RG58 BNC to BNC (length 1.35m 4'6")	002-0404
Probe Lead RG58 (+ Choke) Lemo 00 to Lemo 00 (1.35m 4'6")	001-0436

(For use with Cygnus SE Gauge only)

Probes for Cygnus Intrinsically Safe Mk 1/2 up to S/N 3231

Probe S2C 2.25MHz 13mm (1/2") for Cygnus 1 IS (Mk1/2)	001-9325
Probe S2C 2.25MHz 19mm (3/4") for Cygnus 1 IS (Mk1/2)	001-9324
Probe S3C 3.5MHz 13mm (1/2") for Cygnus 1 IS (Mk1/2) UTG	001-9326
Probe S5A 5MHz 6mm (1/4") for Cygnus 1 IS (Mk1/2)	001-9329
Probe S5C 5MHz 13mm (1/2") for Cygnus 1 IS (Mk1/2)	001-9327
Right Angle Probe S2C 2.25MHz 13mm (1/2") for Cygnus 1IS Mk1/2	001-9372
Right Angle Probe S3C 3.5MHz 13mm 1/2" for Cygnus 1 IS Mk1/2	001-9374
Right Angle Probe S5A 5MHz 6mm (1/4") for Cygnus 1 IS Mk1/2	001-9375
Right Angle Probe S5C 5MHz 13mm (1/2") for Cygnus 1 IS Mk1/2	001-9376

Probes for Cygnus ROV Gauges up to Mk4 S/N 499

Probe S2C 2.25MHz 13mm for Cygnus ROV 1km/3km UTG (5m cable)	003-9393
Probe S2D 2.25MHz 19mm (3/4") for Cygnus ROV 1km/3km UTG	003-9395
Probe S2C 2.25MHz 13mm (1/2") with Nosecone for W1 (5m cable)	001-8317

Battery & Chargers for Cygnus UW / Intrinsically Safe Mk 1/2 up to S/N 3231

Battery for Cygnus UNDERWATER UTG Mk1/2 (Uncharged)	001-1519
Battery Charger (UK) for Cygnus UW / IS Batteries Mk1/2	001-1520
Battery Charger (US) for Cygnus UW / IS Batteries Mk1/2	001-1521
Battery Charger (EU) for Cygnus UW / IS Batteries Mk1/2	001-1522

Cases & fixings

Soft Carry case & foam for Cygnus 2 / 3 / 4 Mk4 UTG	002-4838
Silicone Sleeve for Cygnus 2 HANDS FREE Mk4 Gauge	002-4835
Silicone Sleeve for Cygnus 4 GENERAL PURPOSE Mk4 or TSR	004-4835
Neck strap for use with Cygnus 2 / 3 / 4 Mk4 UTG	002-4841
Leather Case for Cygnus 2 / 3 Mk3 UTG	002-4817
Leather Case for Cygnus 4 Mk 3	004-4804
Carry Case for Cygnus 4 Mk3/SE	004-4823



Cygnus FMD

Ultrasonic Flooded Member Detector

The FMD system comprises of three fundamental parts; the probe and probe handler, the subsea electronics unit and the reporting software. The innovative probe handling self aligns, ensuring correct contact with the member, even when approached from an angle. The probe contact sensor will not allow a test to be taken unless the probe is correctly aligned. The tough, rugged system returns a simple DRY / FLOODED result to the reporting software with results logged at the surface.



Standard items

Order Code

FMD Mk1 Probe / Software / Peli case

110-0320

Peli case containing:

Probe 0.5MHz with cable and connector P/N 110-0201

Software & manual on USB flash drive P/N 110-0316

Electronics, select from:

FMD Mk1 Electronics Module - Stainless Steel

110-0208



FMD Mk1 Electronics Module - Acetal

110-0209



Probe Holder, select from:

#REF!

110-0050



#REF!

110-0051



Probe Holder Handles, select from:

3/4" T-Bar Manipulator Handle

001-8314



1/2" T-Bar Manipulator Handle

001-8315

Fishtail Manipulator Handle

001-8316



FMD component sets, select from:

FMD Mk1 set of ROV components

110-0321

consisting of:

RS232 to USB Serial interface cable P/N 110-0324

Patch cable 0.6m P/N 001-0451

Dual Test Lead RS485 & RS232 to 2 x 9WD M1-FMD P/N 110-0323

FMD Mk1 set of diver components

110-0322

consisting of:

D-Handle for Probe Handler - Stainless Steel P/N 110-0251

Surface PSU & comms connection unit P/N 110-0205

USB 2.0 Cable Male USB A to Male USB B 1.8m P/N 110-0303

3m test cable P/N 110-0315



Cygnus FMD

Ultrasonic Flooded Member Detector

Electronics Support Cage - optional

FMD Mk1 Electronics Module Cable Support Cage

Order Code

110-0213

Test Piece, select from:

FMD Mk1 System Test Piece

110-0204



FMD Mk1 System Test Piece (DRAWING ONLY)

110-0206

(non-discountable)

Umbilical cable, if required select from:

FMD Mk1 120m Umbilical Cable and Reel

110-0211

(non-discountable)

FMD-Mk1 350m + 50m Umbilical Cable and Reel

110-0212

(non-discountable)



SPARES:

FMD Mk1 Probe 0.5MHz, Cable and Connector

110-0201



FMD Mk1 Surface PSU and Comms Connection Unit

110-0205



FMD Mk1 Software and Manual on USB Flash Drive

110-0316

(non-discountable)

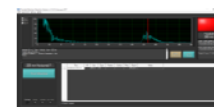

FMD Mk1 Pelican Transit Case

110-0304

(non-discountable)



FMD Mk1 USB 2.0 Cable Male USB A to Male USB B 1.8m

110-0303

FMD Mk1 RS232 to USB cable assembly 1m

110-0324

Patch cable 0.6m for FMD & 2000M/4000M ROV UTG

001-0451

FMD Mk1 3m test cable

110-0315

FMD Mk1 Dual Test Lead RS485 & RS232 to 2 x 9WD

110-0323

Isolated Data Converter (RS422/RS485 to USB)

001-8305

FMD-M1 Subconn Micro Circular Adaptor

110-0302

FMD Mk1 Spares - Subsea Electronics Module O-ring kit (S/S)

110-0317

FMD Mk1 Spares-Subsea Electronics Module O-ring kit (acetal)

110-0318

FMD Mk1 Probe Knurled Ring Nut (S/S)

110-0300

FMD Mk1 Probe Handler Probe Body Spring

110-0301



Cygnus HATCH SURE

Ultrasonic Hatch Leak Detector

The Cygnus Hatch Sure is a lightweight ultrasonic system for checking the weather-tightness of cargo hatch covers. The system consists of a battery powered transmitter which produces an omni-directional sound field, uniformly distributed throughout the cargo hold. The receiver part of the system displays the sound energy level that passes through gaps in the enclosed cargo hold to enable the location of leaks in the hatch seals to be quickly and accurately identified. The system weighs only 3.8 kg and is supplied in a shower-proof, rucksack-style carry case.

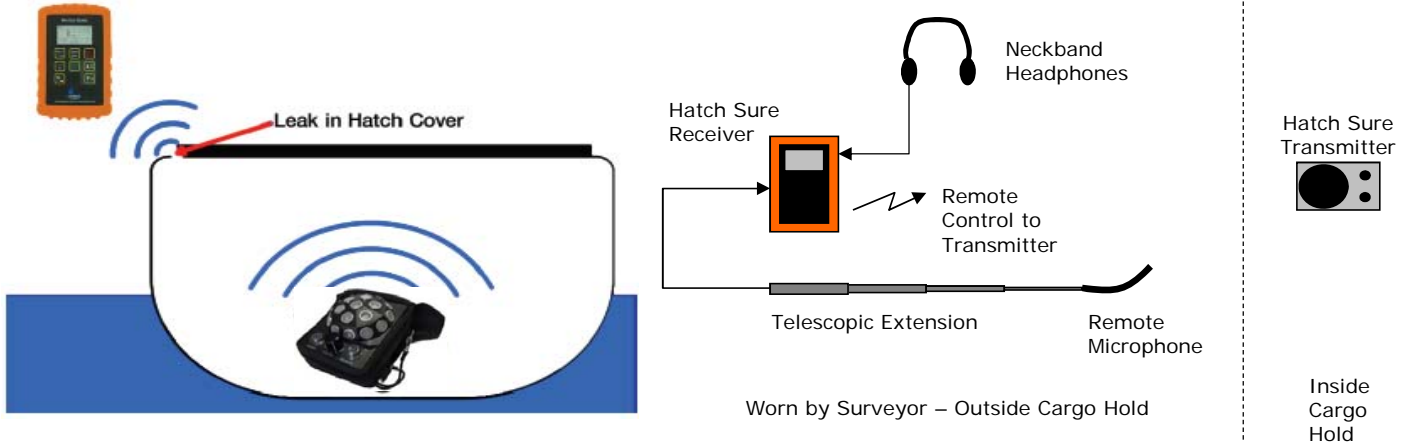

Cygnus HATCH SURE Kit

Order Code

Cygnus HATCH SURE Mk2 Hatch Cover Leak Detection System

Contents: Ultrasonic receiver with protective case - neck & waist straps - 2 flexible inspection microphones - telescopic extension & cable for microphone - neck band headphones - variable output ultrasonic transmitter - with protective case & lowering harness - rechargeable batteries & charger - external 9 - 24 V DC power lead for transmitter - manual & carry case

006-1001



General Spares for Cygnus HATCH SURE

Hatch Sure Mk2 Transmitter Unit
 Cygnus Hatch Sure Mk2 Receiver
 Inspection Microphone (235 x 10mm) for Hatch Sure Mk2
 Foam Cover for Cygnus Hatch Sure Mk2 Inspection Microphone
 Emergency Microphone Cable for Hatch Sure Mk2 Receiver
 Telescopic Extension for Hatch Sure Mk2
 Tripod for use with Hatch Sure Mk2
 Tripod bracket with Velcro for Hatch Sure Mk2 Transmitter
 BNC Straight Adapter for Cygnus Hatch Sure Mk2 Receiver
 Neckband Headphones for Hatch Sure Mk2
 Batteries 6 x AA NiMH MaxE for Hatch Sure Mk2 Transmitter
 Battery PP3 NiMH Max-e x 2 for Hatch Sure Mk2 Receiver
 Battery Charger KH980 for Hatch Sure Mk2 Kit
 DC Power Lead for Hatch Sure Mk2 Transmitter
 Orange Protective Boot for Hatch Sure Mk2 Receiver

006-1010
 006-1012
 006-1020
 006-1018
 006-1016
 006-1003
 006-1056
 006-1054
 006-1017
 006-1004
 006-1005
 006-1006
 006-1007
 006-1008
 006-1013



Inspection microphone



Telescopic extension for microphone



Ultrasonic Thickness Gauge Serial Numbers

Cygnus 2 HANDS FREE

Mk1 produced up to serial no. 1309
Mk2 produced up to serial no. 2146
Mk3 produced from serial no. 2147 (Lemo 00 connector in gauge)
Mk4 produced from serial no. 4000 (Lemo 1 connector in gauge)
Mk5 produced from serial no. 20001 (C2 Lemo 1 connector in gauge & C2+ Twin Lemo 00 connector in gauge)
(There is some overlap between Mk1 and Mk2 and may need to be checked)

Cygnus 3 DATA LOGGER

Mk1 produced up to serial no. 0512
Mk2 produced up to serial no. 0862
Mk3 produced from serial no. 0863 - 0959; 0100 - 0402 (Lemo 00 connector in gauge)
Mk4 produced from serial no. 4000 (Lemo 1 connector in gauge)
(There is some overlap between Mk1 and Mk2 and may need to be checked)

Cygnus 4 GENERAL PURPOSE

Mk2 produced up to serial no. 0333
Mk3 produced from serial no. 0334 (Lemo 00 connector in gauge)
Mk4 produced from serial no. 4000 (Lemo 1 connector in gauge)
Mk5 produced from serial no. 20001 (C4 Lemo 1 connector in gauge & C4+ Twin Lemo 00 connector in gauge)

Cygnus 6+ PRO

Mk5 produced from 20001 (C6+ Twin Lemo 00 connector in gauge)

Cygnus 1 INTRINSICALLY SAFE

Mk1 produced up to serial no. 2125
Mk2 produced from serial no. 2170
Mk3 produced from serial no. 3232
(Serial nos. 2126 - 2169 may be either Mk1 or Mk 2 and will need to be checked)

Cygnus HEAVY DUTY

Mk1 produced up to serial no. 2125
Mk2 produced from serial no. 2170
Mk3 produced from serial no. 3232
Mk4 produced from serial no. 4985
(Serial nos. 2126 - 2169 may be either Mk1 or Mk 2 and will need to be checked)

Cygnus DIVE

Mk1 produced up to serial no. 10421
Mk2 produced from serial no. 11001

Cygnus UNDERWATER

Mk1 produced up to serial no. 2125
Mk2 produced from serial no. 2170
Mk3 produced from serial no. 3232
Mk4 produced from serial no. 4985
(Serial nos. 2126 - 2169 may be either Mk1 or Mk 2 and will need to be checked)

Cygnus ROV MOUNTABLE

Mk2 produced from serial no. 1
Mk3 produced from serial no. 50
Mk4 produced from serial no. 148
Mk5 produced from serial no. 500

Cygnus FMD

Mk1 produced from serial no. 40016

